

ETA Process Instrumentation

www.etapii.com
sales@etapii.com
tel 978.532.1330

New England

Martech Controls

www.martechcontrols.com
sales@martechcontrols.com
tel: 315.876.9120

Upstate New York



Dräger REGARD 3000 Controller

Monitor various gases and vapors with the modular Dräger REGARD 3000 control system. Its multi-colored light signals the status of your gas detection system. The controller allows for up to three I/O modules: Analog Input, Relay Output, and Modbus Gateway. You can monitor up to 4 analog transmitters and control up to 8 relays.



Dräger REGARD 3000

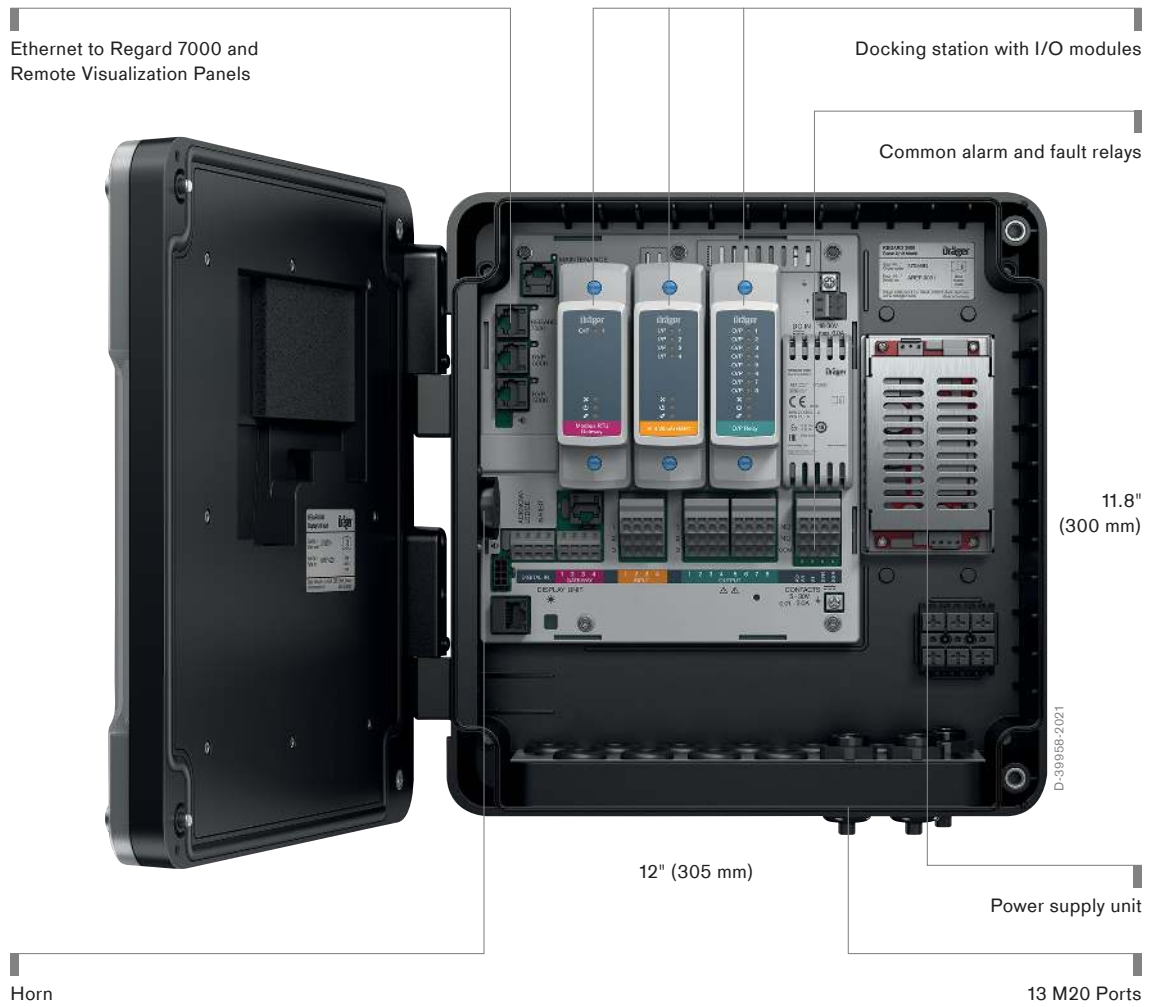

Benefits

Visible and audible

In the event of an alarm, every second counts - but it is also useful to be able to see the status of the gas detection system at a glance. The Dräger REGARD 3000 makes this possible with a bright LED status light around its edge and a built in horn. Different colors clearly indicate whether everything is in order (blue), whether there are malfunctions (yellow) or whether alarms are pending (red). In addition, it can be seen immediately whether the alarm is active (flashing red) or has been acknowledged (continuous red light). This way, everyone on site is informed about the system status and daily checks are made easier. It comes with an integrated horn and is SIL2 capable.

Accessibility

Often gas transmitters are installed in areas that are difficult to access or are far away from each other and the associated control unit. The REGARD 3000's 4 – 20 mA HART® input module gives you central access to all diagnostic information in the event of an alarm or fault. The transmitter configurations can also be read out and transferred conveniently in this way. The intuitive touch display gives you an overview of the status of your gas detection system at all times.

Flexible and expandable

If the range of functions or the size of the gas detection system changes: The REGARD 3000 can be expanded by an additional relay or gateway module, depending on the requirements. This way, the system remains flexible and grows with the plant without having to shut down the production process for a longer period of time. A REGARD 3000 can be equipped with a maximum of one input module, one relay module and one gateway module.

Networking individual systems

Do you have several gas detection systems with REGARD 3000 and REGARD 7000? You would like to have all systems in view and control and configure them centrally? The REGARD 3000 can be connected to an existing REGARD 7000 as a satellite system. The REGARD 3000 then functions as an additional Docking Station for the REGARD 7000. Networked this way, the REGARD 7000 can detect, control and configure multiple REGARD 3000 as satellites.

Cabinet and panel mount

Do you have a control cabinet or control station for your process control system and would like to integrate a gas monitoring system? With the Dräger REGARD 3000, you have the option of integrating the docking station directly into a control cabinet and panel mounting the operating unit (display module) in the control cabinet door. Choose between grey and black housing colors.

Details



D-39969-2021

Dräger REGARD 3000 in normal operation



D-39960-2021

Dräger REGARD 3000 in the event of a failure or fault



D-39961-2021

Dräger REGARD 3000 in the event of a gas alarm

Dräger REGARD 3000 Gas Detection System

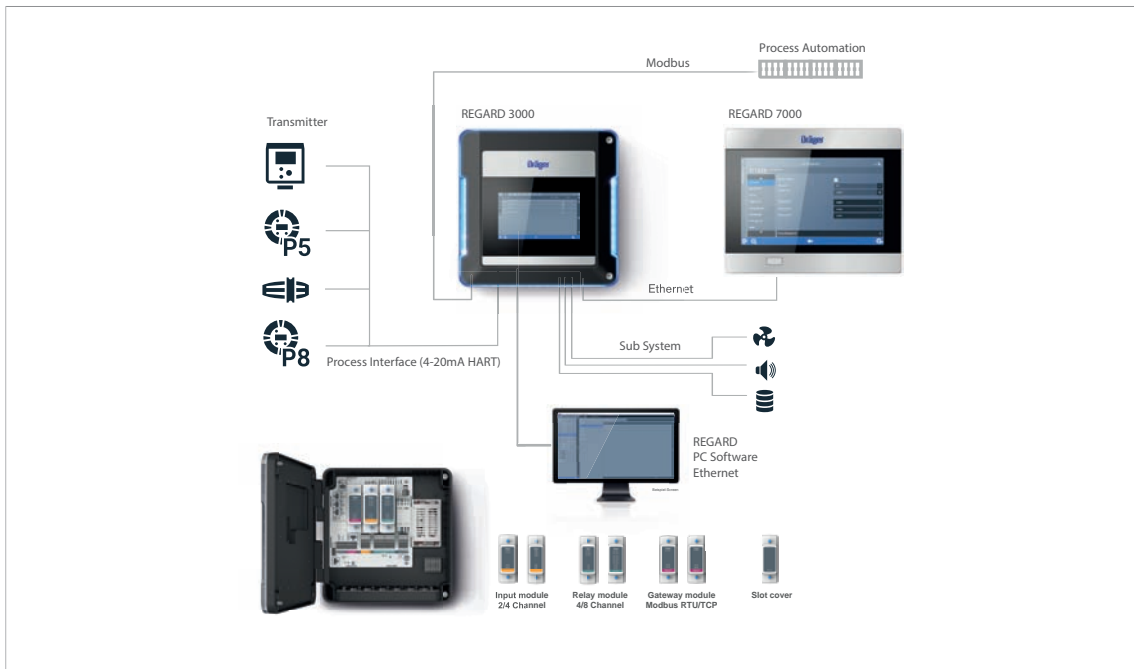

The Dräger REGARD 3000 offers flexible installation and configuration options. Among other things, it can be networked with a process control system or the Dräger REGARD 7000.

Related Products

D-6806-2016



Dräger REGARD 7000

The Dräger REGARD 7000 is a modular and highly expandable control system for monitoring various gases and vapors. Ideal for gas warning systems with various levels of complexity and numbers of transmitters, the Dräger REGARD 7000 delivers exceptional reliability and efficiency. An additional benefit is the controller's backward compatibility with the REGARD.

D-1129-2010



Dräger REGARD 3920

The Dräger REGARD 3920 is a standalone, self-contained control system for the detection of Toxic, Oxygen and Ex hazards. The control system is fully configurable between 1 and 16 channels, depending upon the type and quantity of input/output boards installed.

D-7353-2016



Dräger PointGard 2100

The Dräger PointGard 2100 series is a self-contained gas detection system for the continuous area monitoring of toxic gases in ambient air. PointGard 2100's rugged, water-resistant housing comes complete with a horn and strobes, a built-in power supply, and reliable DrägerSensor®.

Technical Data

Dräger REGARD 3000

Capacity	2 or 4 channels of toxic, oxygen, and combustible gas detection transmitters with user definable measuring ranges, tag names, and engineering units. Compatible with any 4-20 mA transmitter.
Display	7" Diagonal High Definition Touchscreen Color Display Full-text diagnostics for all Dräger HART enabled transmitters. Identifies analog diagnostic signals from any 4-20mA device
User Interface	Automatic configuration of default parameters for Dräger transmitters Warning of HART transmitter configuration mismatch with controller configuration List of all transmitters with values, status information, and tags Password protected menu with multiple user levels Optional PC configuration software for backing up and restoring configuration on a PC or network drive HART multiplexer tunnel for complete configuration of Dräger HART transmitters using optional Dräger Polysoft® PC software
Inputs	2 or 3 wire 4-20 mA transmitters with or without HART Max 500 mA per channel, 2 A / 48 W supply per module 262 Ohm load resistance Remote alarm acknowledge and remote inhibit digital inputs
Relay Outputs	4 common relays: special states, system faults, pre-alarm, and master alarm Optional relay module with 4 or 8 SPDT 2 A AC/DC configurable relays with up to 8 different alarm levels per input channel Single, common, or voting alarm configuration Dry contacts NO/NC/C energized/de-energized, latching/unlatching, time delay 100 to 240 V AC up to 2 A; 5 to 30 V DC from 10 mA to 2 A
Alarm Devices	Status LEDs around the entire circumference of the enclosure Blue LEDs indicates normal operation Yellow LEDs indicate a malfunction with different flash sequences Red LEDs indicate a gas alarm with different flash sequences >85 dB @ 1 m piezo horn indicates different alarm levels
Digital Communication	Optional RS485 Modbus RTU or Modbus TCP/IP output module 2 ethernet outputs for remote visualization panels 1 ethernet output to Regard 7000 controller 1 ethernet output for Regard Configurator PC software
Enclosure	Polycarbonate ABS rated IP65, NEMA 4X (pending)
Size (H x W x D)	11.8" x 12.0" x 5.9" (300 x 305 x 150 mm)
Weight	10.4 lb (4.7 kg) with 3 modules
Ports	13 M20 cable entries
Power Supply	Internal: 90-264 VAC 50-60 Hz 120 W, 24 VDC External: 24 VDC 2A, usually 1A depending on connected transmitters
Ambient Conditions	Temperature (during operation) -20 ... +55 °C Temperature (in storage) -30 ... +65 °C Humidity 5 ... 90 % r.h., non-condensing Pressure 700 ... 1300 hPa
Approvals	Power Supply:

Technical Data

	UL 62368-1, CAN/CSA-C22.2 No. 62368-1-14
	UL 60950-1, CAN/CSA-C22.2 No. 60950-1-07
	47 CFR FCC Part 15 Subpart B: 2016
	SIL 2 Functional Safety EN 50402, IEC 61508-3
	2014/30/EU: EN 50270:2015 (type 2)
	2014/35/EU: EN 61010-1:2010+A1:2019
Performance Approval	ATEX 2014/34/EU: EN 60079-29-1:2016, EN 50104:2019, EN 50271:2018

Ordering Information

Configure your own REGARD 3000 with the components below that can easily be assembled in the field.

As a minimum you must order a base unit, display unit, and 4-20mA input module.

The remaining 2 slots must either be used with slot covers or with 1 relay module and 1 gateway module.

Dräger REGARD 3000	
Dräger REGARD 3000 Base unit black	37 05 684
Dräger REGARD 3000 Base unit grey	37 06 357
Dräger REGARD 3000 Display unit black	37 09 719
Dräger REGARD 3000 Display unit grey	37 05 685
Dräger REGARD 3000/5000 Slot cover	37 05 672
Dräger REGARD 3000 4 – 20mA Input Module 2Ch	37 05 680
Dräger REGARD 3000/5000 4 – 20mA Input Module 4Ch	37 05 681
Dräger REGARD 3000/5000 Relay Module 4Ch	37 05 687
Dräger REGARD 3000/5000 Relay Module 8Ch	37 05 688
Dräger REGARD 3000/5000 MB RTU Gateway Module	37 05 693
Dräger REGARD 3000/5000 MB TCP Gateway Module	37 05 694
Dräger REGARD 3000/5000 PC-Software Key	37 09 533
Preassembled REGARD 3000	
REGARD 3000 Complete Set	NA10792
Base and display unit black	
4-20 mA Input Module 4Ch	
Relay Module 8Ch	
ModBus RTU Gateway Module	

ETA Process Instrumentation

www.etapii.com

sales@etapii.com

tel 978.532.1330

New England

Martech Controls

www.martechcontrols.com

sales@martechcontrols.com

tel: 315.876.9120

Upstate New York